



# Fridley

COMMUNITY CONNECTION

Parks and Recreation Brochure Enclosed

NOVEMBER/DECEMBER 2024  
NO. 250

WE BELIEVE FRIDLEY WILL BE A SAFE, VIBRANT, FRIENDLY AND STABLE HOME FOR FAMILIES AND BUSINESSES.

7071 University Avenue NE  
Fridley, MN 55432  
phone: (763) 571-3450  
FridleyMN.gov

email: info@FridleyMN.gov

Mayor – Scott Lund  
Councilmember-at-Large – David Ostwald  
Councilmember 1st Ward – Tom Tillberry  
Councilmember 2nd Ward – Ryan Evanson  
Councilmember 3rd Ward – Ann Bolkcom  
City Manager – Wally Wysopal



## Winter Parking Reminder: No Overnight Parking

Friendly reminder: Overnight parking on City streets is prohibited from November 1 until April 1 from 2-6 a.m.

**Why are these restrictions in place?**  
Snow plow drivers are often faced with challenges, including low visibility and poor road conditions. When cars or trash bins are on the side of the road, they create additional, unnecessary challenges. Please help keep your property and our drivers safe this winter by following the winter parking requirements. Given the unpredictable nature of winter conditions, these restrictions will be enforced throughout the season.

By removing your vehicle off the street, you are:

- Avoiding a parking violation ticket.
- Making streets safer by allowing plows to clear the full width of the roadway.

- Ensuring there is no damage done to your vehicle from snow being cleared.
- Allowing routes to be more accessible for emergency vehicles.
- Helping snow plow drivers to be able to clear the streets quickly (and sometimes multiple times per day)!

Learn more at [FridleyMN.gov/Parking](http://FridleyMN.gov/Parking).

**Fridley City Code, Chapter 506.05**  
From November 1-April 1 each year, it is a violation to park any vehicle on City streets from 2-6 a.m. It is also a violation to stop, park or leave standing a vehicle in such a manner as to impede the plowing or removal of snow, ice or waste from public streets or highways, regardless of the date or time.



### WHAT'S INSIDE

Organics Recycling Program .....2  
Recycle Smart.....2  
Recycling Drop Off Event.....2  
Download the Tip411 App.....2  
Park System Improvement Plan Update.....3  
Winter Lights Tour.....3  
Enjoy Our Parks this Winter.....4  
Upcoming Heartsaver Classes.....4  
Early Learning Fall Festival .....4  
New 61st Avenue Multimodal Transit Hub .....5  
Change Your Clocks, Change Your Batteries.....5  
Register your SafeCam .....5  
Winter Parking in Effect .....5  
Summer Community Concert Series.....6  
Keep Hydrants Clear This Winter!.....6  
Smart Salting this Winter .....7  
Family Open Gym .....7  
Keep our Wildlife Wild.....8  
Turkey Fun .....8  
WinterFest.....8

### Stay Connected!

- Like Us on Facebook: search City of Fridley
- Follow Us on X: @CityofFridley
- Watch City Programming: Search Fridley Municipal TV
- Sign up for email notifications on [FridleyMN.gov](http://FridleyMN.gov)

PRESORTED STD  
U.S. Postage  
PAID  
Twin Cities, MN  
Permit NO. 92886



### Pumpkin Recycling

**November 1 - 7**  
Springbrook Nature Center Parking Lot  
The pumpkin dumpster will be back at Springbrook Nature Center from November 1-7. Toss your pumpkins in the dumpster, and they will be recycled into compost. Our goal this year is two tons of pumpkins!

\*\*Only pumpkins in the Pumpkin Dumpster, please.\*\*



### Holiday Lights Recycling

**December 2 - January 31**  
Fridley Civic Campus  
We will be collecting broken and non-working holiday lights for recycling from December 2 – January 31. A labeled drop box will be in the lobby at City Hall. Remember to never put string lights, cords, hoses or other tangles in the recycling. These items can jam the machines.

Questions? Call 763-572-3594 or email [Recycling@FridleyMN.gov](mailto:Recycling@FridleyMN.gov).



## Organics Recycling Program Switches to Daily Service

The Curbside Organics Recycling Program recently switched from pickups only on Wednesday to now collecting organics on the same day as garbage, making participation in the program even easier.

The curbside organics collection program picks up food scraps and other compostable materials from your home and delivers it to a commercial composting site. Each household participating in the program diverts an average of over 500 pounds from the landfill each year. Common products that go in the landfill but could be commercially composted instead include food waste, egg shells, coffee grounds, paper towels, fruit and vegetable pits and peels, and more.

To learn about the benefits of curbside organics recycling, we checked in with Fridley resident Beth LaBreche who has lived with her family in Fridley for 45 years. She began

bringing her organics to a drop site for commercial composting in 2016 and signed up for the curbside organics recycling program when it became available in 2018. She says, "I participate in the recycling program because I feel I can throw away food with a clearer conscience. It helps the environment and helps our water supply not to use a garbage disposal."

When asked what she would like other Fridley residents to know about organics recycling, Beth replied **"I would like people to know how easy it is to recycle your organics if you freeze your meat items (no maggots), spray your cart with pepper spray (no squirrels eating the container) and use the little container offered by the city under your sink (no smell)."**

Thank you to Beth and other recyclers who are helping the City meet our recycling goals!



Learn more and sign up for curbside organics recycling at your home at [FridleyMN.gov/Organics](http://FridleyMN.gov/Organics). The curbside organics recycling program costs \$11.75 per month through Republic Services and includes weekly pick up, free compostable bags at Fridley City Hall or Springbrook Nature Center, a kitchen pail and annual vouchers for free compost.

## Recycling Drop Off Event

**November 9 from 8 a.m. - noon**

On November, Fridley residents will have an opportunity for free and reduced recycling of bulky items such as mattresses, appliances, electronics and more! You can receive \$50 off your total with proof of Fridley residence (driver's license, mail or utility bill).

What can that include?

- Two appliances
- A large 60" TV
- A small TV
- Four tires
- And more!

See a full pricing list at [FridleyMN.gov/Dropoff](http://FridleyMN.gov/Dropoff).

All drop-off events will be held at Recycle Technologies Inc. (formerly Green Lights Recycling). Enter at 1525 99th Lane NE, Blaine.

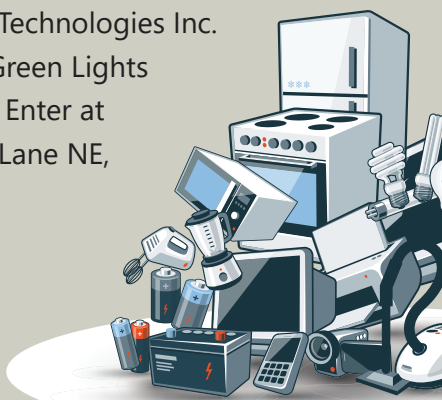

## Recycle Smart – Keep Batteries and Other Hazardous Materials Out of Your Curbside Cart!

Batteries and Battery Enclosed Electronics (household and rechargeable) are recyclable at drop-offs but should not be included in your curbside trash or recycling carts. Cell phones are the most common type of battery-enclosed electronic that are improperly thrown away.

Batteries and electronics, with non-removable batteries can explode and start fires if crushed or punctured. As batteries get stronger, this is

occurring more and more often. Every month, garbage trucks and recycling facilities experience fires due to these types of batteries. Batteries and most battery enclosed electronics can be recycled at no cost at the City's Recycling Drop-off Events or at the Anoka County Household Hazardous Waste Facility located at 3230 101st Avenue NE, Blaine, MN 55449. Find more information at [FridleyMN.gov/Recycling](http://FridleyMN.gov/Recycling).

## Download the Tip411 App

The Fridley Police Department offers the Tip411 system for the public to submit anonymous tips by sending a secure message through a free app, by text or online. If it is an emergency, please call 911.

Your tips are truly anonymous. Any identification information (phone numbers, IP addresses, etc.) are not recorded and cannot be accessed under any circumstances. The tipster's IP address and other identifying information are never retained by the third-party vendor that manages the program. Each tip is assigned a unique identification number, but the tipster's identity is not collected. Learn more at [FridleyMN.gov/Tip411](http://FridleyMN.gov/Tip411).

**Download the App**

Search "Fridley PD" in your Apple or Android App store to submit tips.



# Park System Improvement Plan Update

As part of Fridley’s \$30 million Park System Improvement Plan, our parks continue to grow to meet the needs of our community. Summer construction has wrapped up at Edgewater Gardens Park, Plymouth Square Park and Logan Park. These spaces feature vibrant new playgrounds, tennis, pickleball and basketball courts and even some outdoor fitness equipment at Edgewater Gardens Park.

## Planning for 2025 Parks

As these parks were being improved, planning was underway for our 2025 projects including Oak Hill Park, Jubilee Park and Commons Park. Oak Hill and Jubilee Parks are smaller neighborhood parks and residents should expect them to be closed for most of 2025 so that a safe construction process can occur. Commons Park will be the largest park improvement project in Fridley history and is planned to begin in July of next year so that the ballfields can be used for the spring season.

## Commons Park

Several events and online surveys were held to gather resident input on the Commons Park plan. Thank you to the more than 200 residents that shared feedback, ideas and questions. This \$12 million renovation will include a recreation building, splash pad, inclusive playground, pickleball court complex, ballfields, expanded parking, trails and a winter recreation area.

The recreation building will include activity rooms for a variety of events and programs as well as rental space for small-group gatherings such as meetings and birthday parties. This space will serve as the amenity hub for the

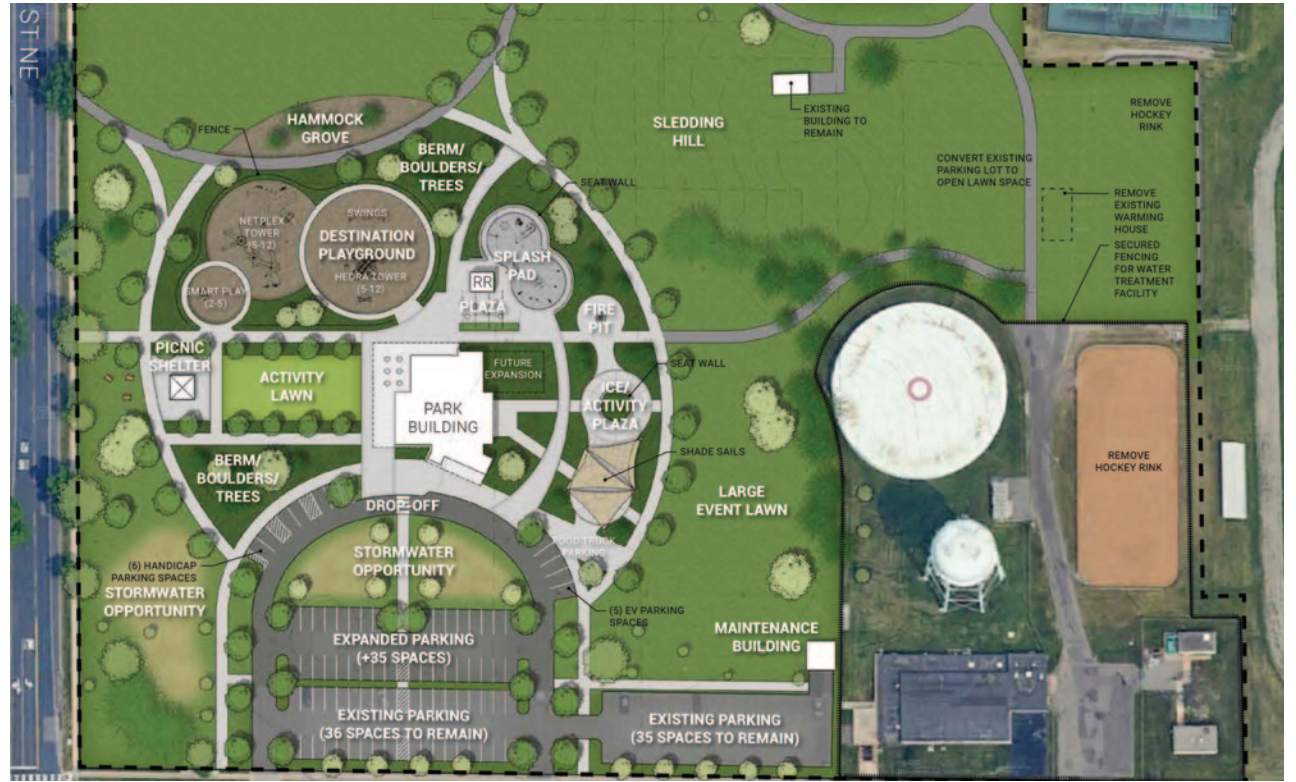

COMMONS PARK SCHEMATIC DESIGN

park, with restrooms, drinking water and winter warming spaces.

An inclusive destination playground will be a highlight of the new park space. This attraction will be designed to allow for individuals of all ages and abilities to play and interact with one another. This feature is supported by a \$500,000 State of Minnesota grant and will feature smooth rubberized surfacing, a fenced enclosure and accessible equipment to allow all to use the space safely.

The outdoor splash pad is an amenity that Fridley residents have been asking for since we began our conversations about improved parks in 2019. This area will be enhanced through funds from the Minnesota DNR outdoor recreation grant program and will be

a favorite for hot summer days for many years to come!

The Commons Park project will impact three ball fields on the south end of the park and through discussions with the Fridley Youth Sports Association, a plan will be implemented to include two new fields on the north end of Commons Park as well as to convert one softball field at Community Park to a baseball field. Soccer fields will also be expanded at Community Park.

Please plan a visit to one of our recently completed neighborhood parks such as Logan Park, Edgewater Gardens Park or Plymouth Square Park and be sure to keep an eye on [FridleyMN.gov/ParkPlan](https://FridleyMN.gov/ParkPlan) for the latest news and updates on park improvements.



## WINTER LIGHTS TOUR

Help spread holiday cheer by decorating the exterior of your home! Entries will be judged on overall impact, visual appeal, uniqueness, variety, and tidiness. Category winners and “Bright Spots” will be indicated on the map.

All entries will be placed on a map so that residents (and visitors) can create their own custom lights tour around town. Judging will take place December 9 - 10. Winners will be announced, and maps will be available on December 13. Tour maps will be available in person at City Hall and at [FridleyMN.gov/Rec](https://FridleyMN.gov/Rec).

Register between November 4 - December 8.

**BUY ONLINE**

Pick up curbside or in-store



**START SHOPPING AT**  
[FridleyLiquor.com/Shop](https://FridleyLiquor.com/Shop)

Available only at the 57th Ave. location (next to Cub Foods)

## Fridley Community Calendar

### November

- November 4 | Parks and Recreation Commission Meeting
- November 6 | Public Arts Commission Meeting
- November 7 | Housing and Redevelopment Authority Meeting
- November 12 | City Council Meeting
- November 12 | Environmental Quality and Energy Commission Meeting
- November 20 | Planning Commission Meeting
- November 25 | City Council Meeting

### December

- December 2 | Parks and Recreation Commission Meeting
- December 4 | Public Arts Commission Meeting
- December 5 | Housing and Redevelopment Authority Meeting
- December 9 | City Council Meeting
- December 10 | Environmental Quality and Energy Commission Meeting
- December 18 | Planning Commission Meeting
- December 23 | City Council Meeting

NOTE: City Council and Commission meetings start at 7 p.m. Meetings are held at the Fridley Civic Campus, 7071 University Avenue NE. The public is welcome.

Upon request, accommodation will be provided to allow individuals with disabilities to participate in any City of Fridley services, programs, or activities. Hearing impaired persons who need an interpreter or other persons who require auxiliary aids should contact the City at 763-572-3450.

## Enjoy Our Parks this Winter



### SNOWSHOEING AND KICKSLEDDING

Snowshoeing and kicksledding are fun and a great workout that can be done on the snow at any of our parks (a three-inch minimum base of snowpack is best). Springbrook Nature Center has snowshoes and kicksleds that are available for rent from the front desk between 9 a.m. and 2 p.m. daily and can be used on-site at Springbrook.

### SLEDDING HILL

If you are looking for a great place to bring the sleds, check out Commons Park!

### ICE SKATING

The City of Fridley maintains four general skating rinks and six hockey rinks in Fridley! General rinks are located at: Briardale, Hackmann, Logan, and Sylvan Hills Parks. Hockey rinks can be found at: Commons (2), Flanery, Madsen, and Ruth Circle Parks, and Hayes Elementary. We need 10 consecutive days of freezing temps to create safe and usable ice.

### WARMING HOUSE AT COMMONS PARK

The Commons Park Warming House will be open this winter! Ice Skates of various types and sizes are available for the public to use for FREE! The warming house will be closed if unsafe ice conditions or extreme cold temperatures are present. For opening day, visit [FridleyMN.gov/WinterParkUse](http://FridleyMN.gov/WinterParkUse).

### CROSS COUNTRY SKI AND MULTI-USE TRAILS

The City of Fridley grooms trails in Moore Lake, Commons, Flanery, Meadowlands, and Riverview Heights Parks. Six-foot trails are groomed including a three-foot section for cross country skiing and a three-foot section for multi-use. Multi-use trails can be used for a variety of activities—walking, fat tire biking, snowshoeing, etc. We do our best to groom the trails weekly depending on snow depths and conditions.



## Family Open Gym

Family Open Gym will return on November 2! Bring the family and get the wiggles out with a variety of activities. This is a perfect time for parents/caregivers and children to have fun and play as the weather turns cold outside. Enjoy free play with a wide variety of recreational equipment including, balls, hoops, scooters, jump ropes, music and more!

### Fees:

Drop-in fee: \$2 per child / \$4 per family  
5 Visit Punch Card: Child \$5 / Family \$10  
(Family = 1 adult & 2+ children)



### Dates:

Saturdays: November 2 – March 1  
10:15 a.m. – 12:15 p.m.  
Gym closed on 11/30, 12/21, 12/28, 1/25)

### Location:

Hayes Elementary School Gymnasium  
(Enter Door #2), 615 Mississippi Street NE



## Upcoming HeartSaver Classes

Fridley Police and Fire want to make Fridley a Heart Safe Community. Sign up for one of our upcoming classes to learn CPR and first aid skills. Classes are open to ages 16 and older. The cost is \$60 per registrant. Learn more and register online at [FridleyMN.gov/HeartSafe](http://FridleyMN.gov/HeartSafe).

### HeartSaver CPR:

December 1 | 8 a.m. - noon

### HeartSaver First Aid:

November 21 | 6 - 10 p.m.

## Turkey Fun

All ages are welcome to join us for a fun afternoon as we play turkey bingo! We'll have turkeys, prizes, and Thanksgiving food items to win! We will also have Turkey themed games and crafts. Get ready for a fun afternoon celebrating turkey day! Registration required for turkey bingo. Register at [FridleyMN.gov/RecRegister](http://FridleyMN.gov/RecRegister).

All Ages Nov 23 2-4 p.m. Free  
Springbrook Nature Center

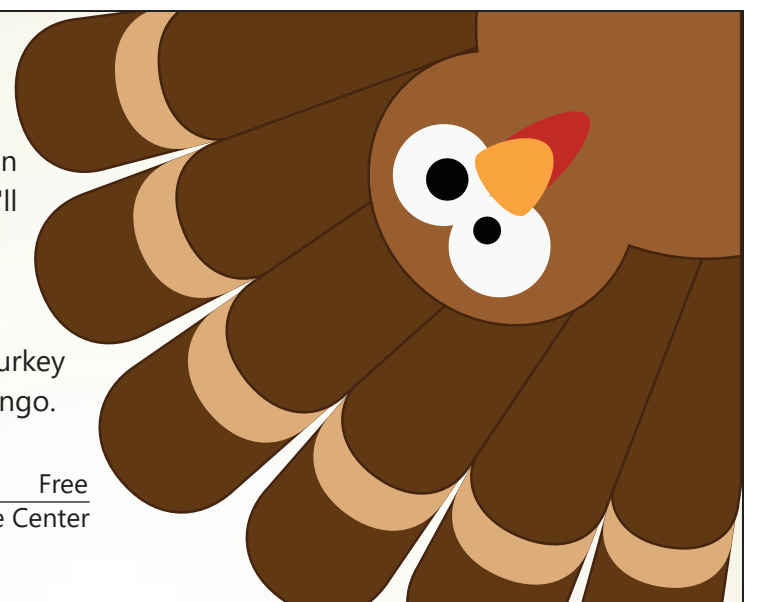



## Stop By The New 61st Avenue Multimodal Transit Hub

The City of Fridley celebrated the completion of the 61st Avenue Multimodal Transit Hub with a ribbon cutting on September 25. The hub is located at the site of a former abandoned gas station that sat vacant for years through many unsuccessful redevelopment attempts. During a series of community workshops in 2019, the property was identified as a potential public amenity that could be used to enhance the University Avenue corridor, improve the travel experience for non-motorized users, and mitigate pollution. The City was able to acquire the site after it was tax-forfeited in 2020. With financial

support from a Community Development Block Grant from Anoka County as well as contributions from the Fridley Housing and Redevelopment Authority, the City was able to redevelop the site as a multimodal transit hub in line with the community vision. Features of the site include walking and biking paths, rentable bike lockers, a bike fix-it station, a bench with solar-powered phone charging capabilities, a water fountain, seating, landscaping and more.

Stop by to visit the hub at the northeast corner of University Avenue and 61st Avenue while



walking or biking to nearby amenities including Commons Park, the North Star Transit Station, and more. If you are interested in renting a bike locker, visit [FridleyMN.gov/GettingAround](https://FridleyMN.gov/GettingAround).

## Change Your Clocks, Change Your Batteries

## Change Your Clocks, Change Your Batteries

It's almost time to "fall back" and change your clocks as daylight savings time ends. Fridley Public Safety also recommends that November is a great time to change the batteries in your smoke detectors and carbon monoxide detectors as well.

### What Your Need to Know

- Carbon monoxide alarms should be installed within 10 feet of each sleeping room or inside each sleeping room.
- Test alarm monthly.
- Follow the instructions on the package to properly install the CO alarm.
- If the battery is low, replace it.

### Prevent CO Poisoning

- When warming a vehicle, move it out of the garage. Opening the garage door is not enough.
- Make sure the exhaust pipe of a running

vehicle is not blocked by snow or anything else.

- During and after a snowstorm, make sure vents for the dryer, furnace, stove and fireplace are clear of snow buildup.
- A gas-powered generator should only be used outdoors and in a well-ventilated location away from windows, doors and vent openings.
- Gas and charcoal grills can produce CO – only use them outside.
- Never use your oven or stove to heat your home.
- Have heating equipment and chimneys inspected by a professional now, before the cold weather hits. Get yearly inspections.

For questions about fire safety and preventing CO poisoning, contact Fridley Fire Division by email at [FridleyFire@FridleyMN.gov](mailto:FridleyFire@FridleyMN.gov) or by calling 763-572-3613.

## Register Your Surveillance Camera With SafeCam

Do you have a surveillance camera at your residence or business? If so, Fridley Public Safety would like to partner with you to help keep your neighborhood safe.

Registering for the SafeCam program only adds the location of the surveillance camera to the Public Safety Department's database. This allows officers to contact the owner should a crime occur in or near where the camera is installed. The department does not have direct access to your footage.

Learn more and register online at [FridleyMN.gov/SafeCam](https://FridleyMN.gov/SafeCam).



## MINIATURE TAPESTRY

Join fiber artist Becka Rahn to create your own small woven masterpiece using a laser cut bamboo loom. Learn how to combine and weave with yarns, wool roving, beads and textured threads to create a landscape or abstract design.

Ages 12+ Th Jan 30 6 - 8 p.m. \$25  
Moore Lake Community Building



## Summer Community Concert Series

The 2024 Fridley Parks and Recreation Community Concert Series was a success complete with music, food, activities and dancing! Concerts were held June – August at the Civic Campus, Springbrook Nature Center, Moore Lake and an additional children’s performance held at the Commons Park. A total of nine concerts were held with an average attendance of 200 per concert, with a total of 1,300 concertgoers for the series! Rain was not our friend this summer, and we had to cancel a handful of concerts that we were not able to reschedule.

Concert goers enjoyed the wonderful music, games from our Rec ‘N Roll mobile and food from local food trucks, The Rustic Chef and Flamingo’s Ice Cream. The 2024 line up included a wide variety of genres from quality performers: Southside Aces (Jazz), Los Rebeldes (Tex-Mex), Dia Toti (RnB), Sawyers Dream (Rock/Americana), Socaholix (Caribbean/Calypso), Fridley City Band, and Shrek the Musical JR. by ETC Productions.

### Children’s Performance

This year’s children’s performance was Shrek the Musical JR. and was held at Commons Park. The musical was performed by Education-Theater-Community (ETC) Productions, which employs high school kids from the metro doing theatrical performances as their summer jobs. The show brought over 400 kids, adults and even a few summer care facilities to the park to watch this free event. Folks attending the performance enjoyed a free kid’s book swap, a visit from the Fire truck and firefighters and free Jonny Pops popsicles. Thank you to Jonny Pops for donating to multiple community events this year!

### Touch-a-Truck

On August 20, before the concert, we held our annual Touch-A-Truck event from 5-7 p.m. The event featured multiple vehicles from Public Works, Fridley Fire engine, Fridley Police cars, Schmit Towing truck, Voigt’s school bus, MN DOT snow plow, Allina ambulance, electric vehicles, lawn equipment, two inflatables generously donated by the Fridley Lions, food trucks and activities. A State Patrol helicopter was scheduled to attend, but was unable to

land - however, many folks still enjoyed watching it come close in the sky!

Kids of all ages enjoyed climbing and exploring the vehicles. We are grateful to the Fridley Public Works staff, Fridley Public Safety staff, Rachel Workin - City of Fridley Environmental Planner, Anoka County Library Mississippi Branch, Schmit Towing, Allina EMS, Voigt’s Bus Company, Fridley Lions, MN State Patrol, MNDot, Springbrook Nature Center Foundation, Rustic Chef Food Truck, and Flamingo’s Ice cream for their contributions to make this event successful. We had 700+ community members in attendance and received positive feedback from many folks in the community.

We appreciate everyone who joined us for this year’s concerts and events! We look forward to welcoming you again at the 2025 Community Concert Series.

If you are someone you know is interested in performing for next year’s concert series, please visit [FridleyMN.gov/Rec](https://www.fridleymn.gov/Rec) to submit an interest form for consideration.

# KEEP THEM CLEAR

3 FEET

3 FEET

**Keep snow and ice  
3 feet away  
from fire hydrants.**

**Every second counts. In case of fire,  
firefighters need to be able to get  
to hydrants quickly.**

## Keep Hydrants Clear This Winter!

Fridley firefighters would like to remind residents about the importance of keeping neighborhood fire hydrants shoveled out and accessible to firefighters.

When fire hydrants become covered with snow, it can delay firefighters in securing a water source at a fire scene, when every second counts.

### Keep an eye on hydrants.

Winter weather can create fire safety hazards, such as ice or heavy snowfall, that can obstruct fire hydrants. You can help reduce the risk by keeping fire hydrants accessible and clear of ice and snow.

Fire trucks carry a limited amount of water, so one of the first tasks upon arriving at a fire is to locate a water supply from the nearest hydrant. Hydrants covered in snow can be difficult to locate and uncovering them can waste valuable time needed during the firefighting operations.

Keeping them clear can mean easier access to water and more time doing what really matters — fighting the fire.

### How to keep fire hydrants clear.

In addition to removing snow and debris covering the hydrant itself, clearing a three-foot area around the hydrant for easier access is recommended.

Maintaining a shoveled path from the street, sidewalk or driveway to the fire hydrant is important so that it is visible from the road and firefighters can easily access it.

### Who should clear hydrants?

Although there are few hard and fast rules concerning who should clear hydrants, it is generally considered the responsibility of the residents occupying the property near a hydrant.

Consider helping elderly friends, neighbors or those with medical conditions keep their fire hydrants clear. If you would like to adopt a fire hydrant in the City of Fridley, please visit our website at [FridleyMN.gov/978/Adopt-A-Hydrant](https://www.fridleymn.gov/978/Adopt-A-Hydrant).

# Smart Salting this Winter

Did you know one teaspoon of salt can permanently pollute five gallons of water? Salt and de-icers contain chlorides, which can enter our waterways as snow and ice melt. Springbrook Creek is already listed by the Minnesota Pollution Control Agency as vulnerable to chloride contamination, and other Fridley waterbodies are close behind. Chloride contamination can kill fish and plants and cause drinking water to have a salty taste. If you use salt during the winter, please follow these smart salting tips from our partners at the Mississippi Watershed Management Organization (MWMO):

- 1) More salt does not equal faster melting — just more pollution and wasted money. Shoot for a three-inch spread between salt granules. For \$10–\$20, a hand spreader can make the job easier and more accurate. To be more exact, try to apply no more than one pound per 250 square feet of pavement. (Tip: A regular-size coffee mug typically holds about one pound of salt.)
- 2) If you must apply salt or de-icer, clear off any loose and/or compacted snow first. Apply the product on ice only; do not apply it on dry pavement. Temperatures often

drop after a snowstorm, so double-check the label on your salt or de-ice product to make sure it will work before you apply it. Rock salt does not work below 15°F. You can use this table from MWMO to check the lowest pavement temperature for different types of de-icers.

- 3) Sweep any extra salt once the ice is gone to keep it from washing into the storm sewers.

| Melting Agent              | Lowest Melting Temp | Things to Know                                                                                         |
|----------------------------|---------------------|--------------------------------------------------------------------------------------------------------|
| Urea                       | 20°F                | Promotes algae growth in waterways; over-application can harm plants; slow-acting; relatively pet safe |
| Sodium Chloride (NaCl)     | 15°F                | Harmful to plants; harmful to concrete; very corrosive to metal, cheap and abundant                    |
| Magnesium Chloride (MgCl2) | -10°F               | Harmful to plants, corrosive to metal, relatively high cost                                            |
| Potassium Acetate (KAc)    | -15°F               | Can cause surface slickness; lowers oxygen levels in waterways; biodegradable, relatively high cost    |
| Calcium Chloride (CaCl2)   | -20°F               | Corrosive to metal; leaves slimy residue; less harmful to concrete                                     |
| Sand                       | No melting          | Provides traction only; potential pollutant; can be swept up and re-used                               |

## Fridley businesses and institutions:

Planning to store a large amount of salt this winter? All bulk salt storage must be located on an impervious surface and covered by a roof or securely fastened impermeable cover. Remember to sweep up any remaining salt or sand after the ice melts to help protect our water bodies.



**REGISTER NOW** 



SCAN ME

# PRESCHOOL ENROLLMENT

Monday-Friday | Noon - 2:45 p.m.



Play-based learning



International Baccalaureate curriculum



Outdoor play

Monday - Friday Noon - 2:45 p.m.  
**Seats still available - don't miss out!**  
 Contact Karin at 763-502-5117 or  
 BeckStrand@isd14.org



Fridley Public Schools is the only program in the state of MN to offer the full International Baccalaureate (IB) Programme Continuum to all Prek through grade 12 students.



Early Learning at Fridley Community Center

## Fall Festival

NOVEMBER 9TH

- Photo Booth
- Bouncy House
- Kids Activities
- Crafts
- Face Painting
- Winter Gear Exchange
- And More

**Cost: Free**

**Who: Families with children newborn to age 5 (whole family event)**

**Where: Fridley Community Center**

**Time: 11 AM - 2 PM**

**REGISTER TODAY:**  
[Fridley.ce.eleyo.com/search?g=fall+festival&redirected\\_yet=truepar](https://fridley.ce.eleyo.com/search?g=fall+festival&redirected_yet=truepar)





## Keep our Wildlife Wild – Please Don't Feed Deer or other Wildlife in Fridley

As temperatures cool this fall and winter, wildlife in Fridley adapts to the change in our climate. Animals take three basic approaches to the harsh Minnesota winter. Some, like the American Goldfinch, will migrate to warmer climates and abundant food. Others, like turtles or snakes, will slow their bodies and rest beneath the ground or water. Last are those that brave the harsh winter, like White-tailed Deer or Coyotes.

There is a natural tendency to feel empathy for these animals that may not enjoy the human comforts of winter such as heated homes, insulated clothing or a steaming mug of hot chocolate. Many of us, with good intention, turn to feeding wildlife during the winter months. In some cases, however, feeding wildlife can cause more harm than good.

Deer provide one of the most dramatic example of unintentional harm from feeding. Ingesting too much feed such as corn can

cause a fatal disease commonly called grain overload. Bacteria naturally found in the deer's digestive system react to high volumes of grain and produce toxins that can be fatal to the deer within 24 hours.

Grain overload is not the only negative impact that can be seen from feeding deer in an urban setting. When deer congregate at a feeding station, there is an increased risk of disease transmission. Chronic Wasting Disease as well as several other bacterial infections can be spread when deer gather together and share feed.

In addition to risk of disease, feeding deer also changes their behavior in ways that can be harmful to the deer and to our residents. Deer are more likely to cross roadways to find a known source of food like a feeding station, leading to an increase in auto accidents. Larger congregations of deer can also lead to conflict with neighbors who may not want deer on

their properties or visiting their gardens or bird feeders. **For these reasons, feeding wildlife in Fridley is prohibited by City ordinance.**

For those residents that do want a close look at winter wildlife, feeding birds can be a great option that presents far fewer issues that feeding deer. Black-oil sunflower seeds can attract beautiful Cardinals and Chickadees while suet (animal fat) feeders attract a variety of beautiful birds such as the striking Pileated Woodpecker. To avoid attracting deer and other animals to your bird feeders, be sure to hang them at least six feet above ground level.

Fridley's Springbrook Nature Center provides a great resource to discover winter birds. A feeding station is located outside of the nature center's exhibit space and our friendly staff loves to share tips and tricks for bird feeding and identification.

SAVE THE DATE

# winterfest



Noon - 3 p.m. | Saturday, January 25  
Springbrook Nature Center, 100 85th Avenue NE

Wander through our Winter Wonderland with activities for the whole family!

### ACTIVITIES INCLUDE:

Medallion Hunt  
Ice Bowling  
Kick Sleds

Snowshoeing  
Snow Painting  
S'mores

Snowball Launcher  
Storytime  
Campfires

Zumba  
Hot Cocoa  
And more!



### WINTER GEAR DRIVE:

Let's keep each other warm! We will be accepting donations of gently used/new winter gear starting December 1 at both Civic Campus and Springbrook Nature Center (during business hours). Please bring in freshly washed or new items. All donated gear will be available free of charge during Winterfest.